

Meeting & Event Venues





Sasin

School of Management



Toemsakdi Krishnamra Hall

- ↑ Toemsakdi Krishnamra Hall
- Branches: Lomprab Suba
- Branch: Hall
- ← Reception
- Branch/Connect
- Go/Bus

venue



Toemsakdi Krishnamra Hall (TK Hall) and Sasa Commons



Total Area

TK Hall:

Area: 300 sq.m.
(90 - 180 seats)

Sasa Commons:

Area: 227 sq.m.
(54 seats)

Amenities

- 2 Projectors
- LED Screens
- Desktop Computer
- Wireless Microphone
- Sound System
- Wifi
- Lobby Area

Room Rates

Monday - Saturday:

Half Day: 28,000 Baht
Full Day: 50,000 Baht

Sun & Holidays:

Half Day: 33,000 Baht
Full Day: 60,000 Baht

Scan to view 360°



Layouts

Layout 1 for Sit-down Dinner & Cocktail: 50 pax



Layout 2 for Seminar: 180 pax



Layout 3 for Seminar: 180 pax

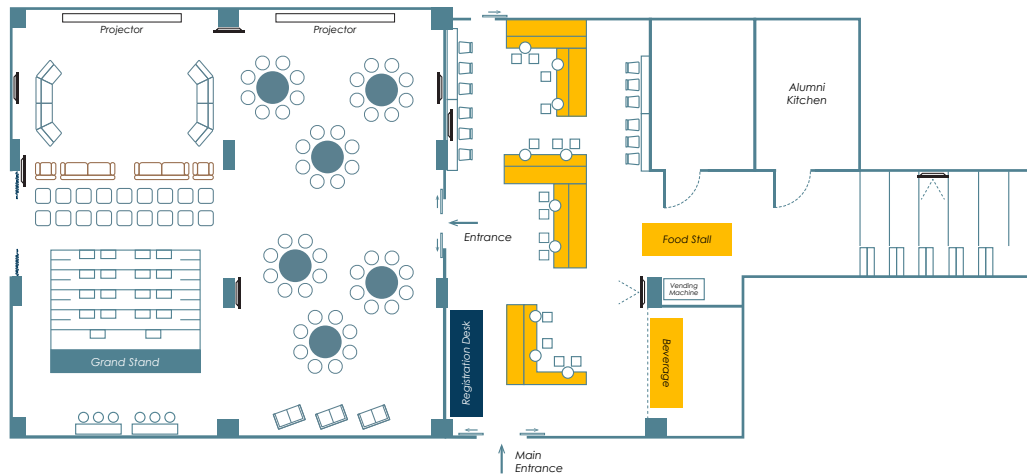

Layout 4 for Seminar and Cocktail: 80 pax



Layout 5 for Cocktail: 120 - 150 Pax





Bancha Lamsam Suite

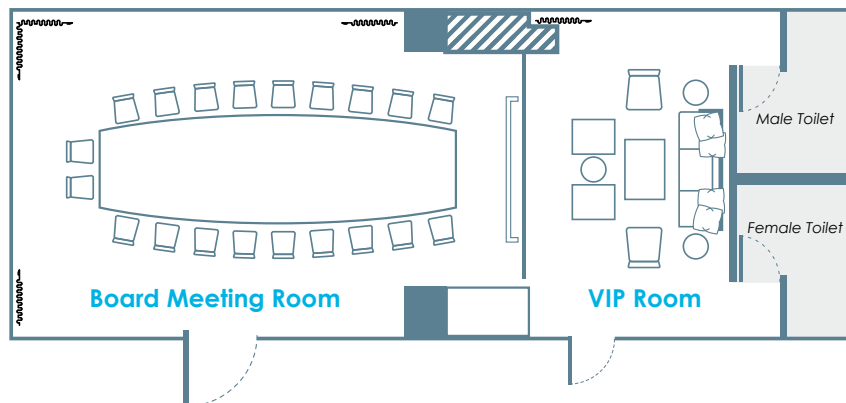

Total Area

Area: 52.2 sq.m. (20 seats)

Amenities

- Video Wall
- Desktop Computer
- Desktop Microphones
- Sound System
- Wifi
- VIP Room

Room Rates

Monday - Saturday:

Half Day: 12,000 Baht

Full Day: 22,000 Baht

Sun & Holidays:

Half Day: 15,000 Baht

Full Day: 28,000 Baht

Scan to view 360°



2nd Floor

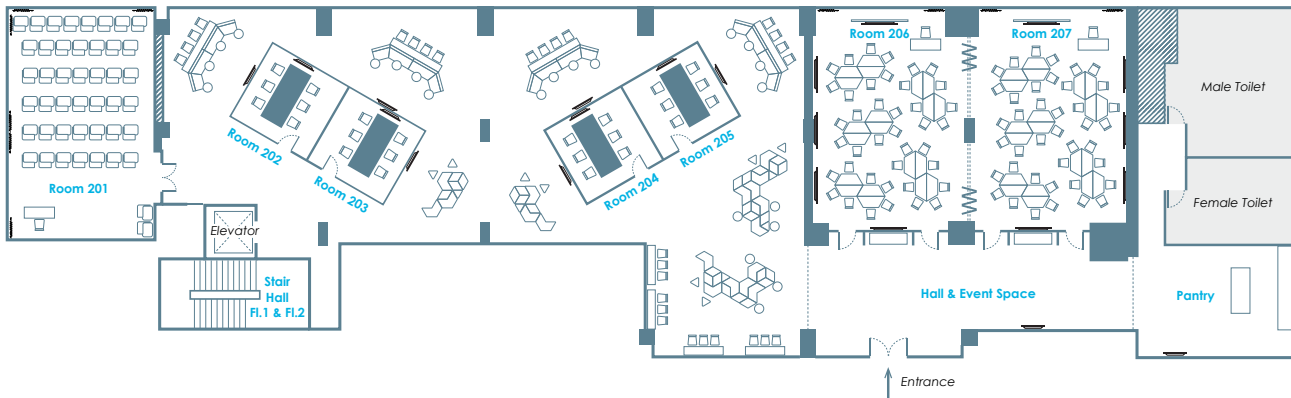



Room 201 Speakers' Corner

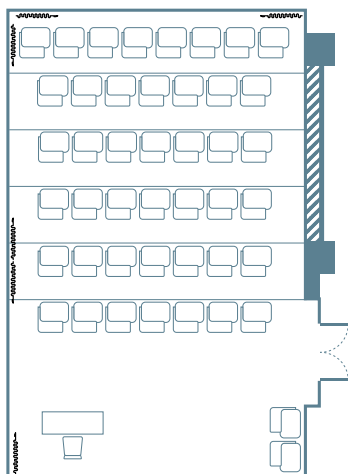

Total Area

Area: 100 sq.m. (43 seats)

Amenities

- Video Wall
- Desktop Computer
- Wireless Microphone
- Sound System

Room Rates

Monday - Saturday:

Half Day: 16,000 Baht

Full Day: 28,000 Baht

Sun & Holidays:

Half Day: 19,000 Baht

Full Day: 35,000 Baht

Scan to view 360°



Room 202-205 Meeting Rooms

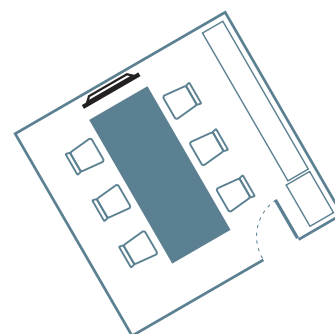

Total Area

Area : 24 sq.m (6 seats)

Amenities

- LED Screen
- Whiteboards
- Internet connection
 - LAN port
 - Wifi

Room Rates

Monday - Saturday:

Half Day: 2,500 Baht

Full Day: 4,500 Baht

Sun & Holidays:

Half Day: 3,000 Baht

Full Day: 5,500 Baht



Room 206 - 207 Workshops

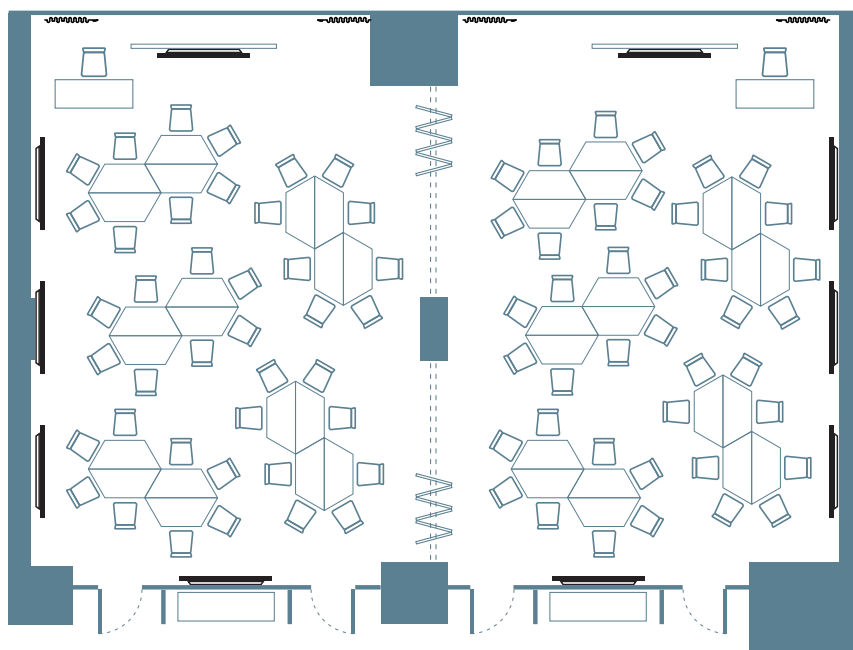

Room 206

Room 207



Individual

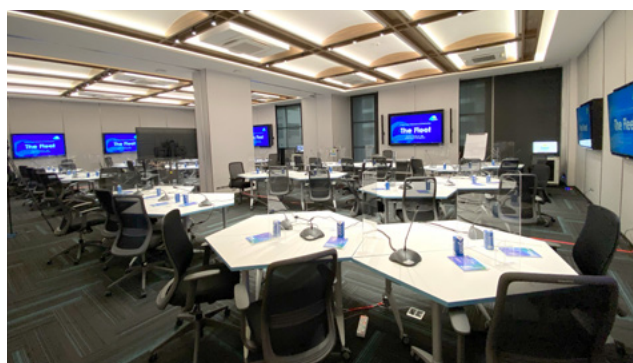

Connected

Total Area

Individual : 107 sq.m. (40 seats)
Connected : 214 sq.m. (80 seats)
Foyer : 30 sq.m.

Amenities

- LED Screens
- Desktop Computer
- Wireless Microphone
- Sound System
- Wifi
- Lobby Area

Room Rates

Monday - Saturday:

Half Day: 16,000 Baht
Full Day: 28,000 Baht

Sun & Holidays:

Half Day: 19,000 Baht
Full Day: 35,000 Baht

Scan to view 360°



Layouts

Layout 1: 40 pax/room

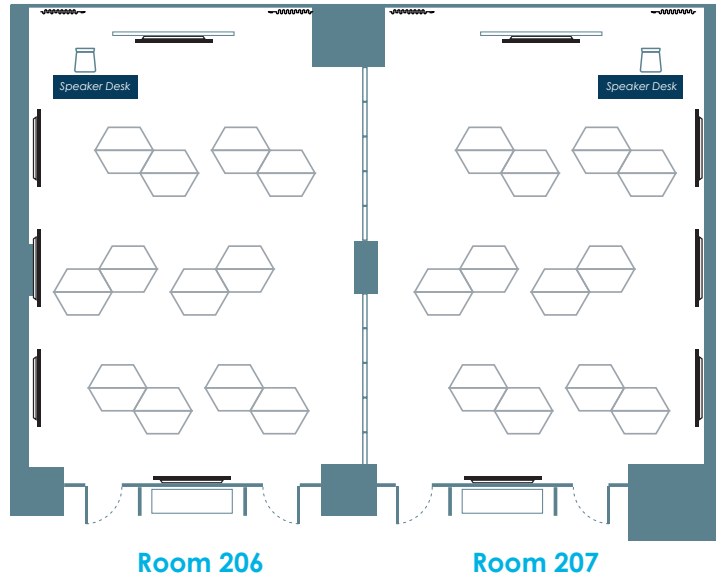

Layout 2: 80 - 100 pax

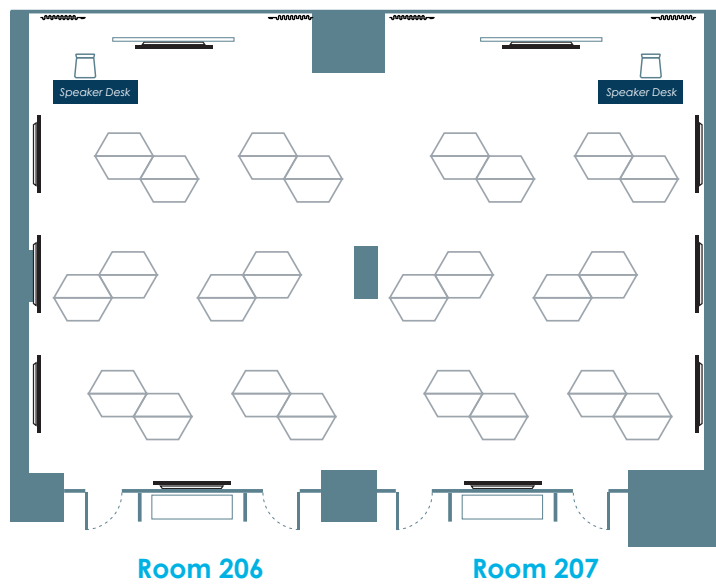

Layout 3: 72 pax

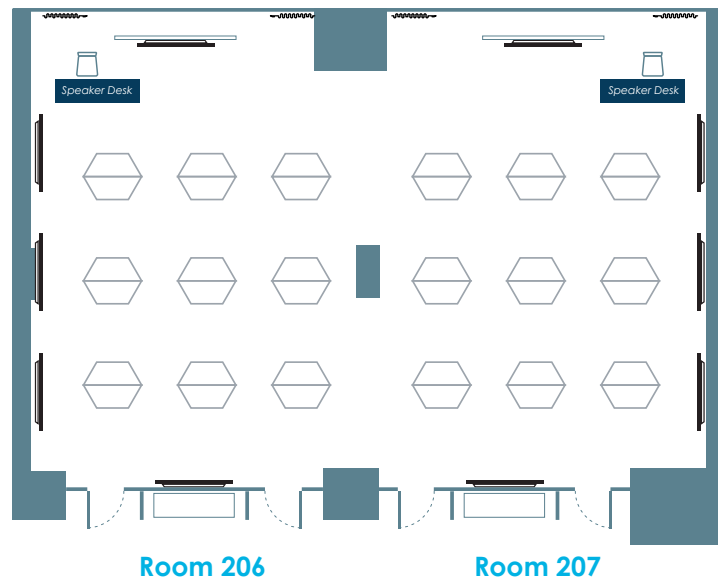

Layout 4: 30 pax/ room

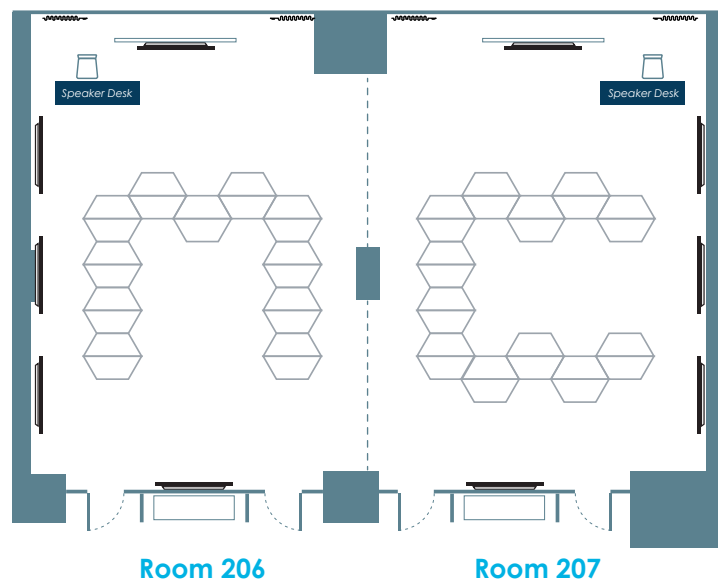

Layout 5

Room 206: 30 pax | Room 207: 40 pax

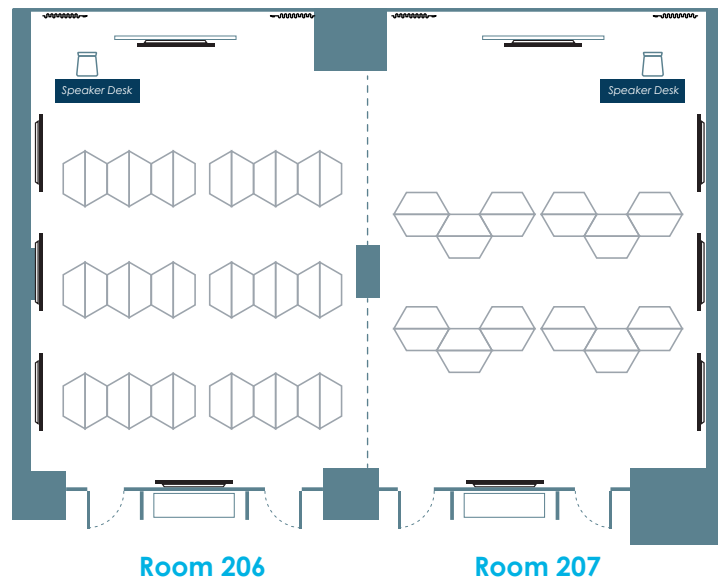

Layout 6

Room 206: 36 pax | Room 207: 40 pax

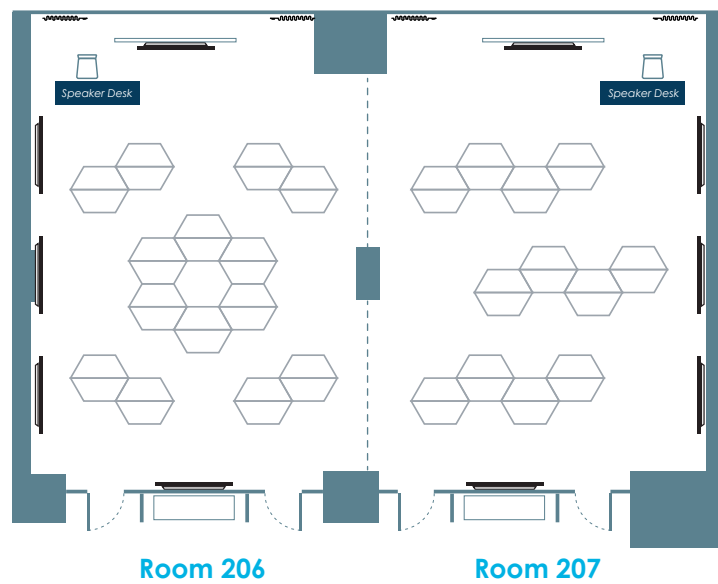

4th Floor

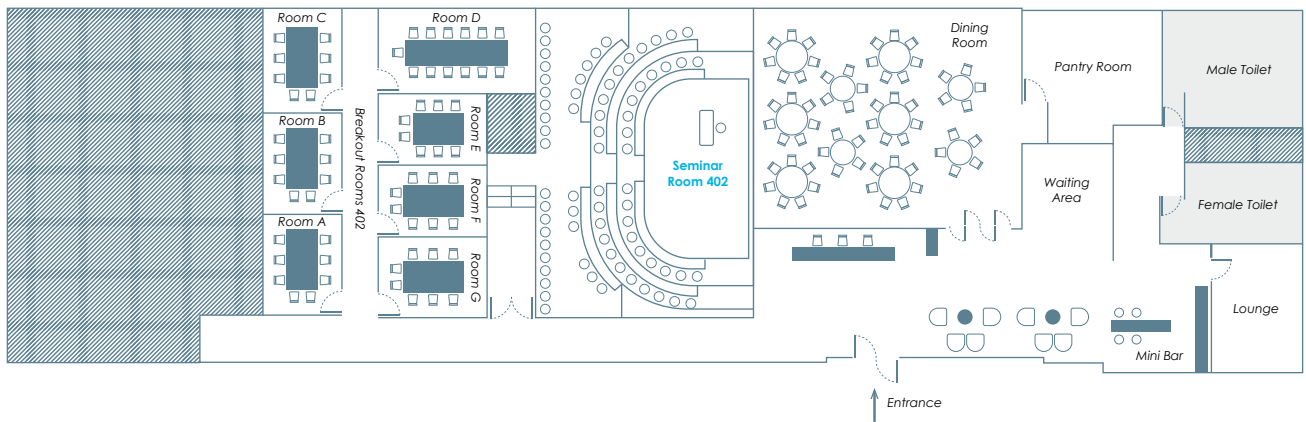



Seminar Room 402

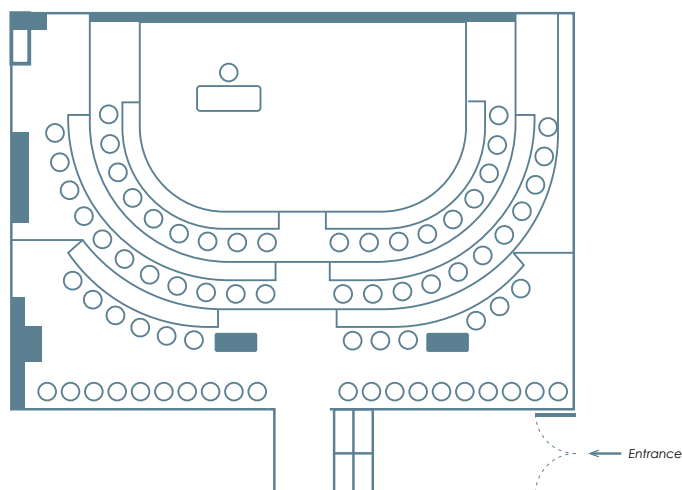

Total Area

Area: 120 sq.m. (52 seats)

Amenities

- Projector
- Desktop Computer
- Desktop Microphones
- Wireless Microphone
- Whiteboards
- Sound System
- Wifi
- Lobby Area
- Dining Room
- 7 Breakout Rooms

Room Rates

Monday - Saturday:

Half Day: 26,000 Baht

Full Day: 46,000 Baht

Sun & Holidays:

Half Day: 30,000 Baht

Full Day: 55,000 Baht

Scan to view 360°



5th Floor

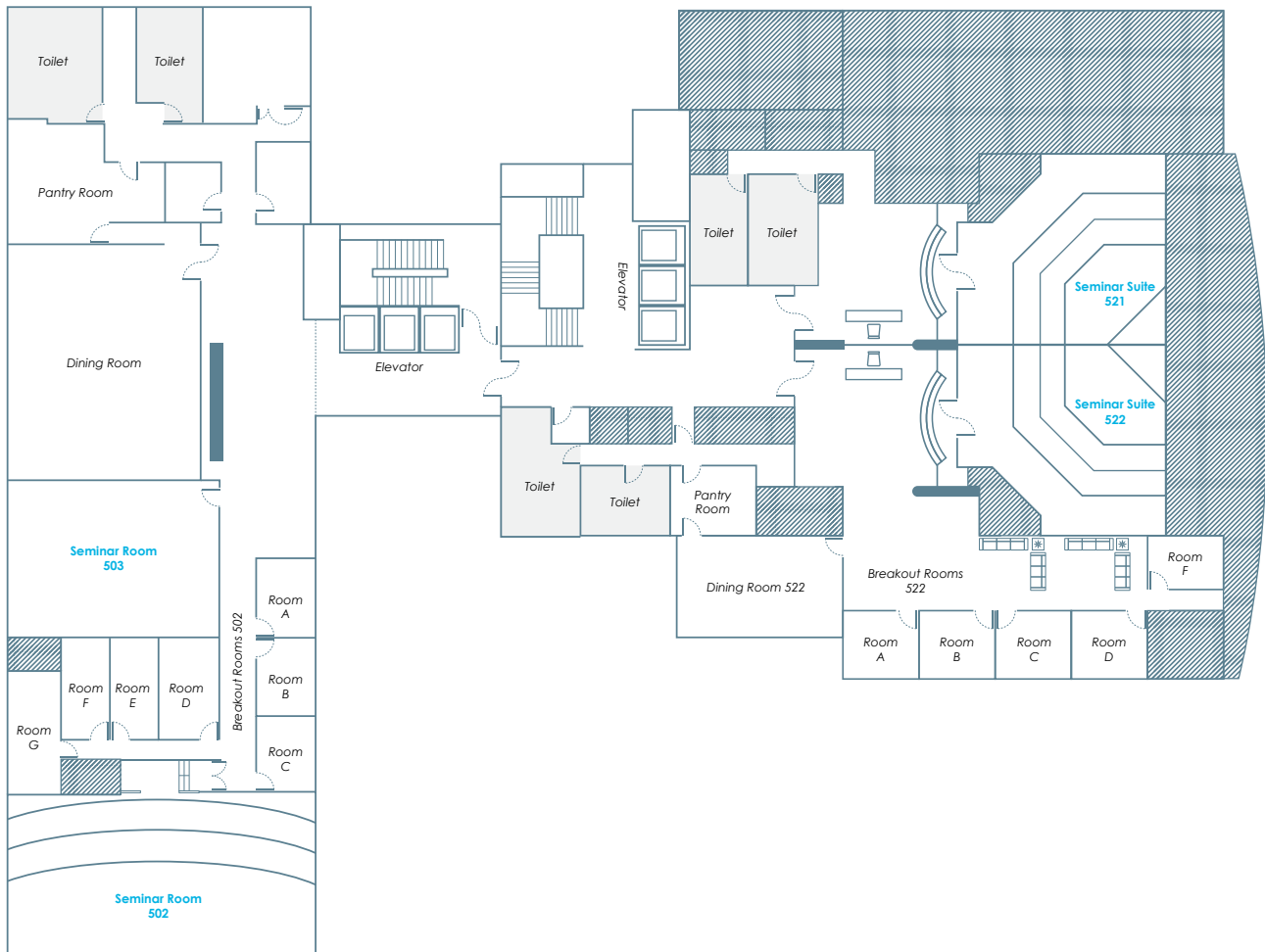



Seminar Room 502

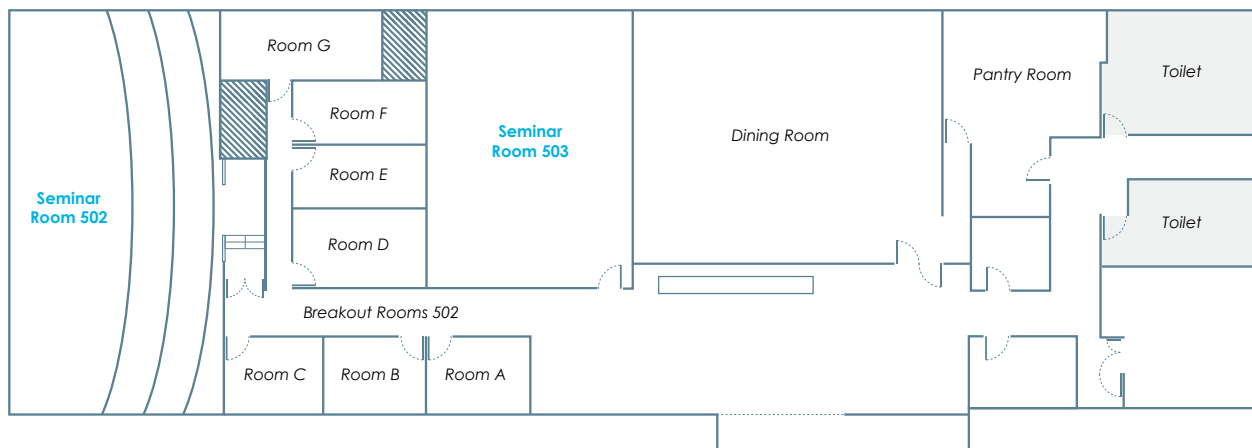

Total Area

Area: 140 sq.m. (50 seats)

Amenities

- Video Wall
- Desktop Computer
- Desktop Microphones
- Wireless Microphone
- Whiteboards
- Sound System
- Wifi
- Lobby Area
- Dining Room
- 7 Breakout Rooms

Room Rates

Monday - Saturday:

Half Day: 26,000 Baht
Full Day: 46,000 Baht

Sun & Holidays:

Half Day: 30,000 Baht
Full Day: 55,000 Baht



Seminar Room 503



Total Area

Seminar Room 503:

Area: 100 sq.m. (30 seats)

Room Rates

Monday - Saturday:

Half Day: 26,000 Baht

Full Day: 46,000 Baht

Sun & Holidays:

Half Day: 30,000 Baht

Full Day: 55,000 Baht

Amenities

- LED Screen
- Wireless Microphone
- Whiteboards
- Sound System
- Wifi
- Lobby Area
- Dining Room
- 7 Breakout Rooms



Seminar Suite 521

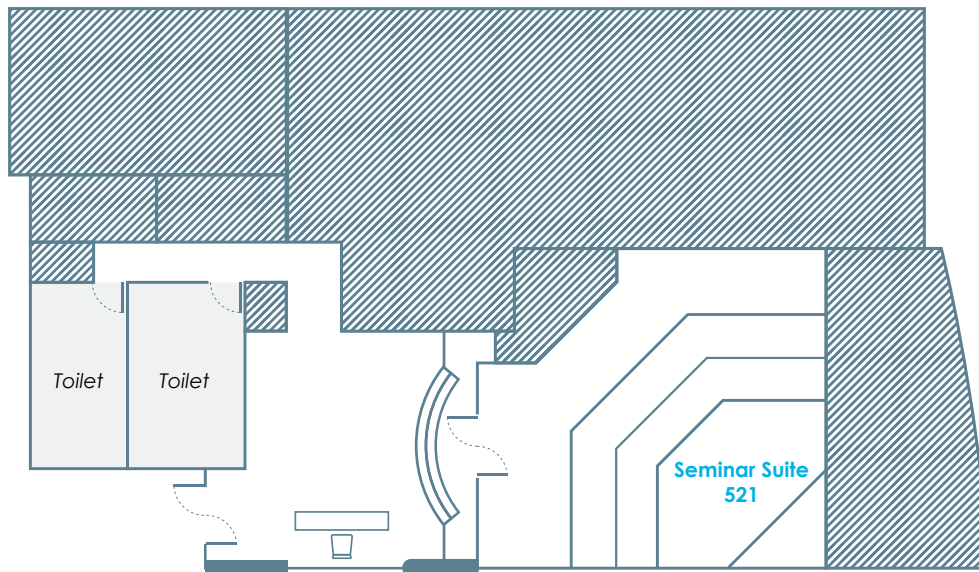

Total Area

Seminar Room 521:

Area: 110 sq.m.
(36 seats)

Amenities

- Projector
- Desktop Computer
- Desktop Microphones
- Wireless Microphone
- Whiteboards
- Sound System
- Wifi
- Lobby Area

Room Rates

Monday - Saturday:

Half Day: 22,000 Baht
Full Day: 40,000 Baht

Sun & Holidays:

Half Day: 25,000 Baht
Full Day: 45,000 Baht



Seminar Suite 522

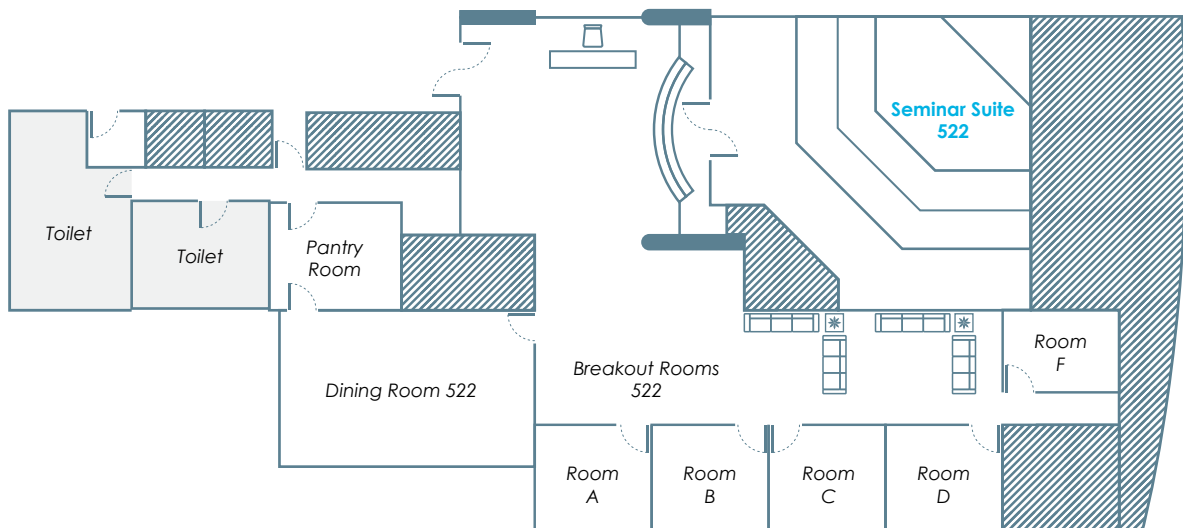

Total Area

Seminar Room 522:

Area: 110 sq.m.
(36 seats)

Amenities

- Projector
- Desktop Computer
- Desktop Microphones
- Wireless Microphone
- Whiteboards
- Sound System
- Wifi
- Lobby Area
- Dining Room
- 5 Breakout Rooms

Room Rates

Monday - Saturday:

Half Day: 22,000 Baht
Full Day: 40,000 Baht

Sun & Holidays:

Half Day: 25,000 Baht
Full Day: 45,000 Baht



Sasin Studio

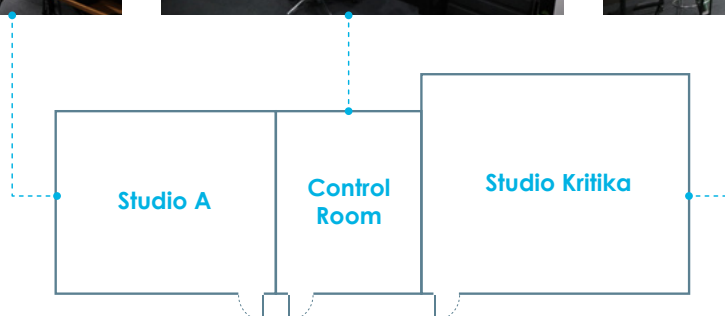
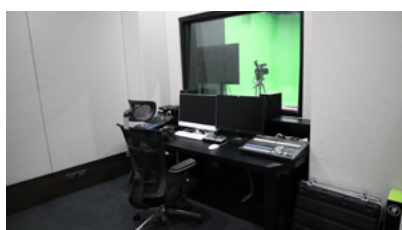

Total Area

Studio A

Area : 20 sq.m.

Studio Kritika

Area : 45 sq.m.

Room Rates

Studio A

Monday - Saturday:

Half Day: 12,000 Baht

Full Day: 22,000 Baht

Sun & Holidays:

Half Day: 15,000 Baht

Full Day: 28,000 Baht

Studio Kritika

Monday - Saturday:

Half Day: 28,000 Baht

Full Day: 50,000 Baht

Sun & Holidays:

Half Day: 33,000 Baht

Full Day: 60,000 Baht

Amenities

Studio A

- Desktop All in One
- 12-Channel Mixing Console
- Professional Monitor Headphones
- Audio Interface
- 2 Ways Wireless Audio + In ear
- Pro Tools Education + iLok License
- DSLR Camera
- 2-Stage Aluminum Tripod System
- Capture Card HDMI to USB 3.0
- Display Monitor 55"
- Monitor 24"
- Software / Live Production / Streaming
- SD Card SDXC 128 GB
- HDMI SPLITTER 1x4
- Backdrop Green Screen 3 x 6 m.
- Studio Light 150W
- Lighting Controller
- Amphenol Microphone Assemblies 3 m.
- Power Conditioner for Audio

Studio Kritika

- Desktop All in One
- 12-Channel Mixing Console
- Bodypack Wireless System
- Professional Monitor Headphones
- Audio Interface
- Monitor Studio Speaker
- 4K Professional Camcorder HDMI Out
- Stage Aluminum Tripod system
- Live Stream Switcher
- Monitor 24"
- Software / Live Production / Streaming
- SD Card SDXC 128 GB
- HDMI SPLITTER 1x4
- Studio Light 150W
- DMX Lighting Controller
- SPLITTER DMX BOOSTER
- Amphenol Microphone Assemblies 3 m.
- Power Conditioner for Audio

7th Floor



Research Center

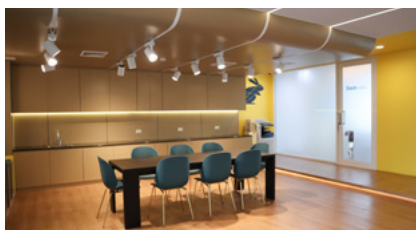
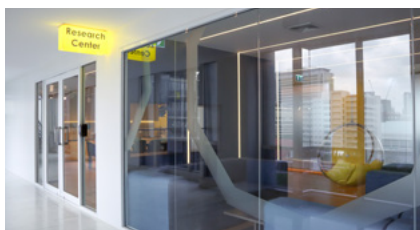
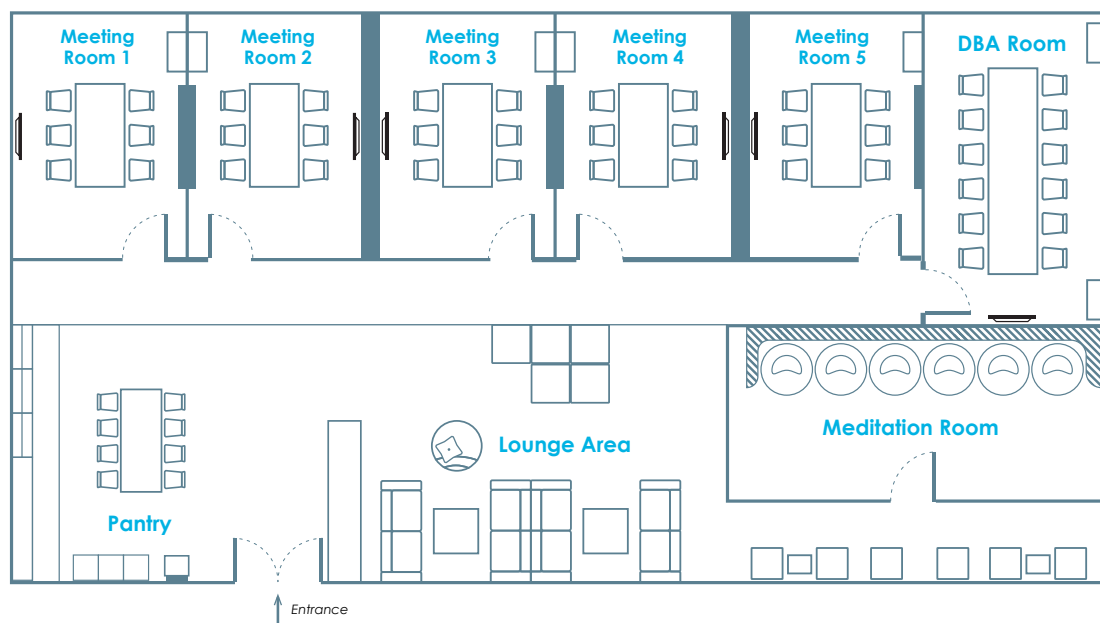

Total Area

Area : 350 sq.m.

Amenities

- LED Screen
- Whiteboards
- Internet connection
 - LAN port
 - Wifi
- 5 Meeting rooms (6 seats/room)
- 1 Meeting room (12 seats/room)
- Meditation room (6 seats)
- Lounge Area
- Dining Area

Room Rates (Meeting Room)

Monday - Saturday:

Half Day: 2,500 Baht

Full Day: 4,500 Baht

Sun & Holidays:

Half Day: 3,000 Baht

Full Day: 5,500 Baht



Seminar Room 704

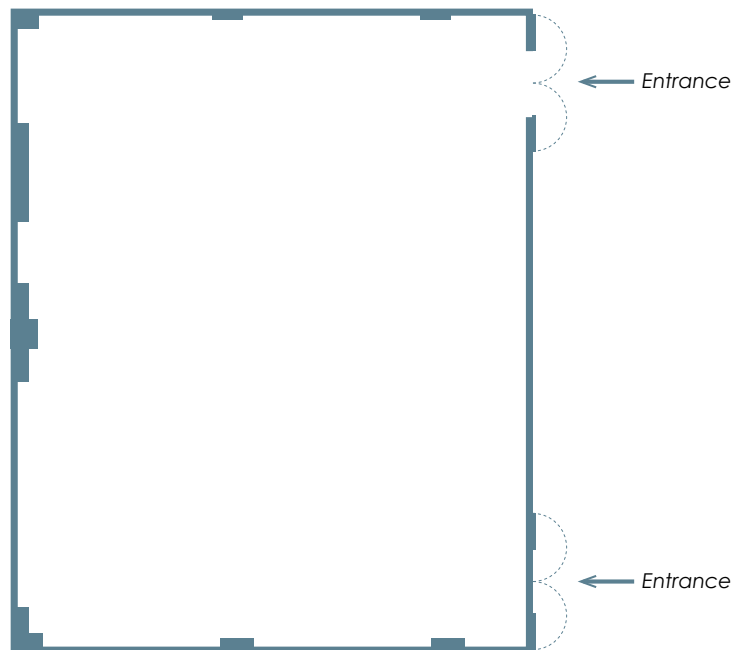

Total Area

Area : 230 sq.m. (168 seats)

Amenities

- Projector
- Wireless Microphone
- Sound System
- Wifi

Room Rates

Monday - Saturday:

Half Day: 22,000 Baht

Full Day: 40,000 Baht

Sun & Holidays:

Half Day: 25,000 Baht

Full Day: 45,000 Baht

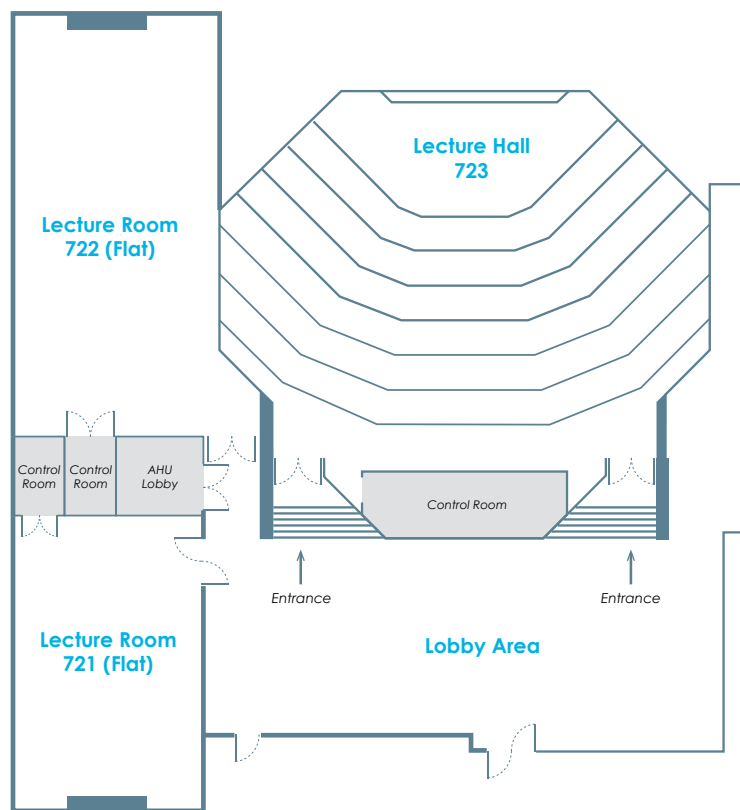

Lecture Room 721



Total Area

Area : 90 sq.m. (25 seats)
Foyer : 180 sq.m.

Amenities

- Projector
- Desktop Computer
- Wireless Microphone
- Whiteboards
- Sound System
- Wifi
- Lobby Area

Room Rates

Monday - Saturday:

Half Day: 9,000 Baht
Full Day: 16,000 Baht

Sun & Holidays:

Half Day: 12,000 Baht
Full Day: 22,000 Baht



Lecture Room 722



Total Area

Area : 135 sq.m. (40 seats)
Foyer : 180 sq.m.

Amenities

- Projector
- Desktop Computer
- Wireless Microphone
- Whiteboards
- Sound System
- Wifi
- Lobby Area

Room Rates

Monday - Saturday:

Half Day: 12,000 Baht
Full Day: 22,000 Baht

Sun & Holidays:

Half Day: 15,000 Baht
Full Day: 28,000 Baht



Lecture Hall 723



Total Area

Area : 280 sq.m. (150 seats)
Foyer : 180 sq.m.

Amenities

- Video Wall
- Desktop Computer
- Desktop Microphones
- Wireless Microphone
- Whiteboards
- Sound System
- Wifi
- Lobby Area

Room Rates

Monday - Saturday:

Half Day: 28,000 Baht
Full Day: 50,000 Baht

Sun & Holidays:

Half Day: 33,000 Baht
Full Day: 60,000 Baht

8th Floor

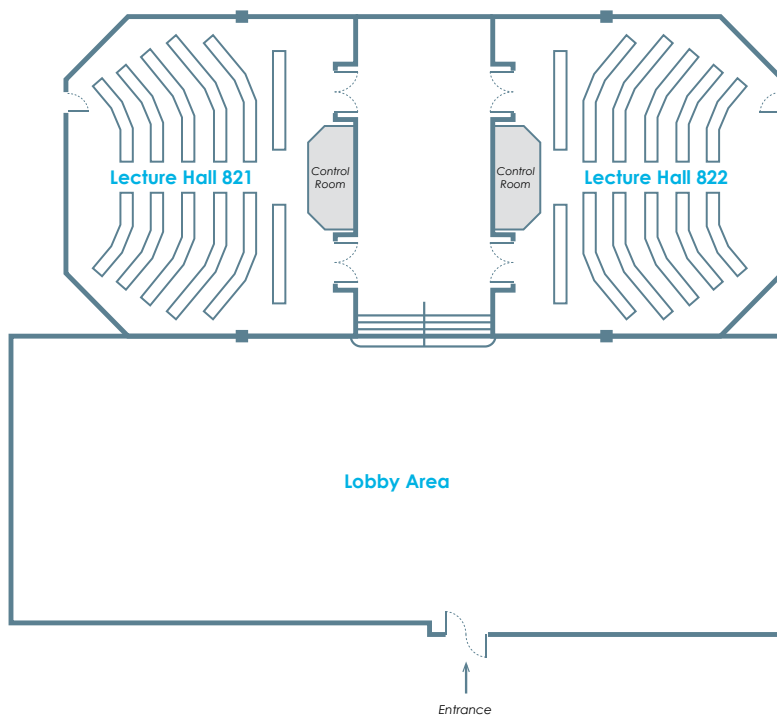

Lecture Hall 821



Total Area

Area : 180 sq.m. (90 seats)
Foyer : 500 sq.m.

Amenities

- Video Wall
- Desktop Computer
- Desktop Microphones
- Wireless Microphone
- Whiteboards
- Sound System
- Wifi
- Lobby Area

Room Rates

Monday - Saturday:

Half Day: 26,000 Baht
Full Day: 46,000 Baht

Sun & Holidays:

Half Day: 30,000 Baht
Full Day: 55,000 Baht



Lecture Hall 822



Total Area

Area : 180 sq.m. (90 seats)
Foyer: 500 sq.m.

Room Rates

Monday - Saturday:

Half Day: 26,000 Baht
Full Day: 46,000 Baht

Sun & Holidays:

Half Day: 30,000 Baht
Full Day: 55,000 Baht

Amenities

- Projector
- Desktop Computer
- Desktop Microphones
- Wireless Microphone
- Whiteboards
- Sound System
- Wifi
- Lobby Area

9th Floor



Sasin Hall

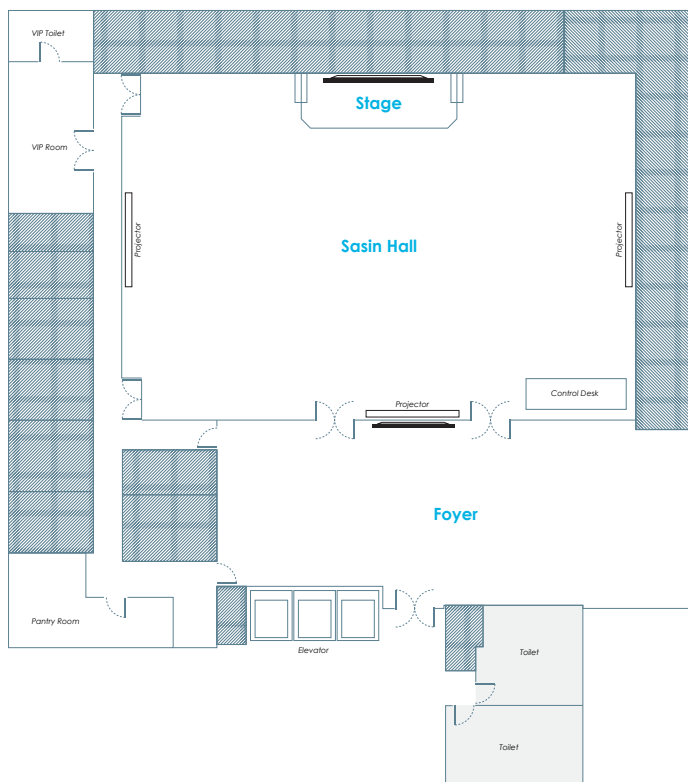

Total Area

Sasin Hall :

Area: 470 sq.m.
(50 - 280 pax)

Foyer:

Area: 240 sq.m.

Room Rates

Monday - Saturday:

Half Day: 42,000 Baht
Full Day: 78,000 Baht

Sun & Holidays:

Half Day: 48,000 Baht
Full Day: 85,000 Baht

Amenities

- LED Screen
- 3 Projectors
- Wireless Microphone
- Sound System
- Light System
- Wifi
- Stage: Width 8.1 m.
Depth 2.78 m. Height 0.54 m.
- Lobby Area
- VIP Room

Scan to view 360°



Layouts

Sasin Hall

Layout 1: 200 pax

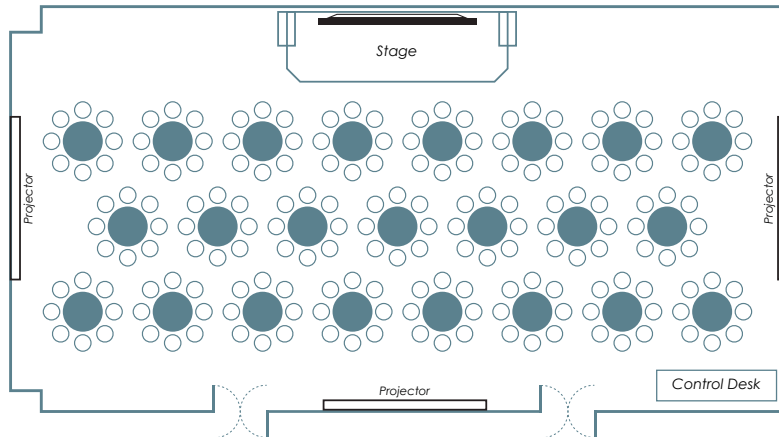

Layout 2: 400 pax

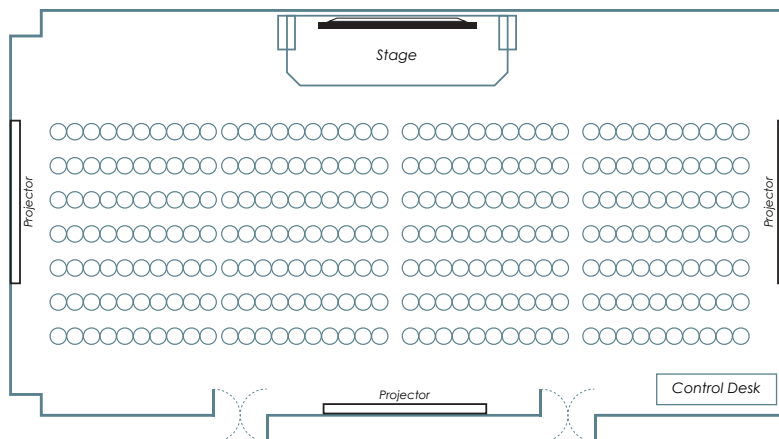

Layout 3: 200 pax

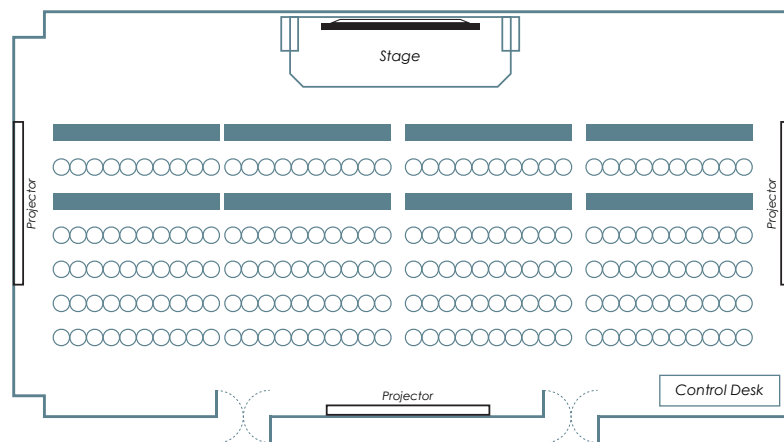

Layout 4: 100 - 160 pax

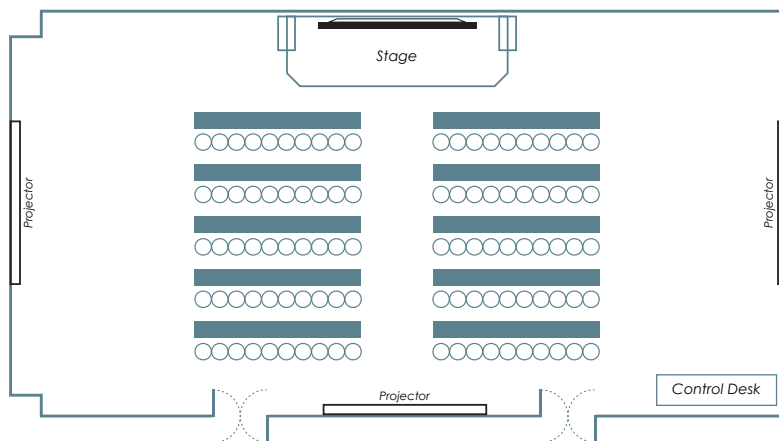

Foyer

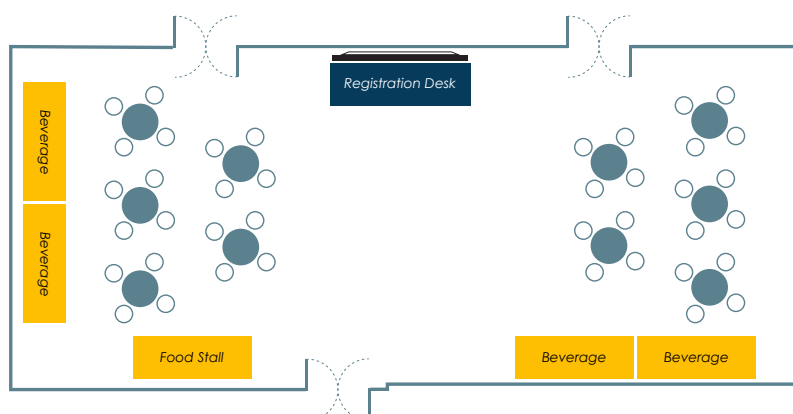



Room Rates

Room	Floor	Room Rates (Monday - Saturday)		Room Rates (Sun & Holidays)	
		Half Day	Full Day	Half Day	Full Day
Toemsakdi Krishnamra Hall (TK Hall)	1	28,000	50,000	33,000	60,000
Bancha Lamsam Suite	1	12,000	22,000	15,000	28,000
Room 201	2	16,000	28,000	19,000	35,000
Room 202, 203, 204, 205	2	2,500	4,500	3,000	5,500
Room 206, 207	2	16,000	28,000	19,000	35,000
Room 402	4	26,000	46,000	30,000	55,000
Room 502	5	26,000	46,000	30,000	55,000
Room 521	5	22,000	40,000	25,000	45,000
Room 522	5	22,000	40,000	25,000	45,000
Studio A	6	12,000	22,000	15,000	28,000
Kritika Studio	6	28,000	50,000	33,000	60,000
Research Center (Meeting room)	7	2,500	4,500	3,000	5,500
Room 704	7	22,000	40,000	25,000	45,000
Room 721	7	9,000	16,000	12,000	22,000
Room 722	7	12,000	22,000	15,000	28,000
Room 723	7	28,000	50,000	33,000	60,000
Room 821	8	26,000	46,000	30,000	55,000
Room 822	8	26,000	46,000	30,000	55,000
Sasin Hall	9	42,000	78,000	48,000	85,000

Contact Info

Sasin Facilities



+66 2 218 4045



facilities@sasin.edu